

FUTURE DEVELOPMENT THE FUNCTION CENTRE PROJECT

PLANNING AND DEVELOPMENT

With members always at the forefront of the Club's future development plans, it was only fitting that the proposed project for 23/24 was the Club's Function Centre, which includes the Whitlam Theatre.

The entire of Level 1 will undergo a major renovation, commencing from January 2024 and due to reopen in late October 2024.

This area over the years has had only minor refurbishments, so these major works will ensure the technology is current, the layout configurations maximise space and we are able to provide state-of-the-art, modern, and flexible facilities to all those who utilise our functions area.

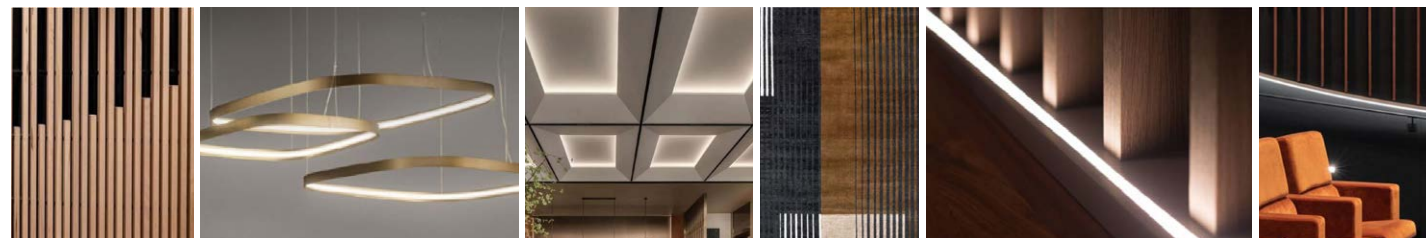
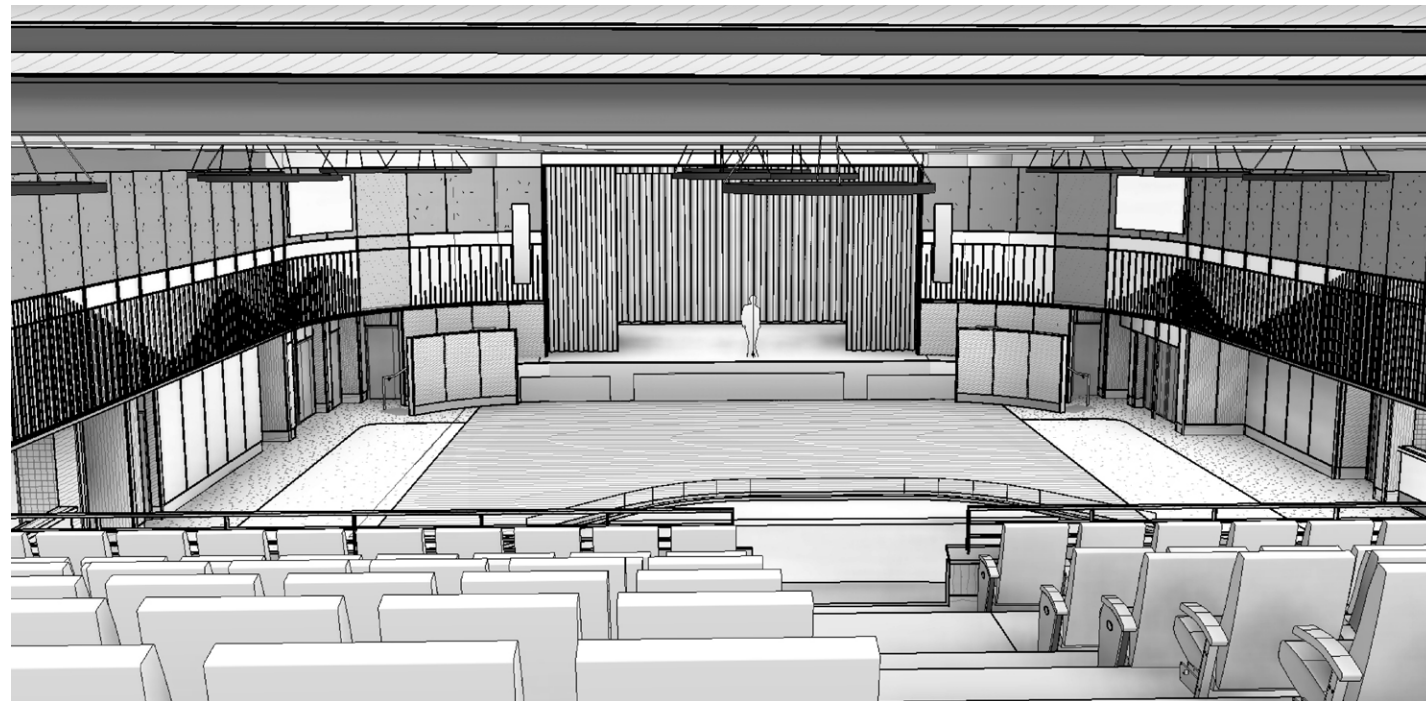
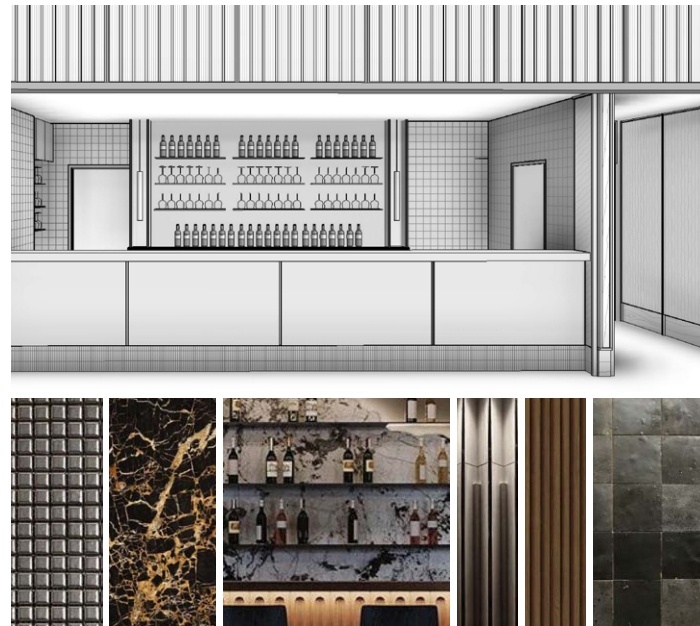

Whitlam Theatre and Bar Facilities

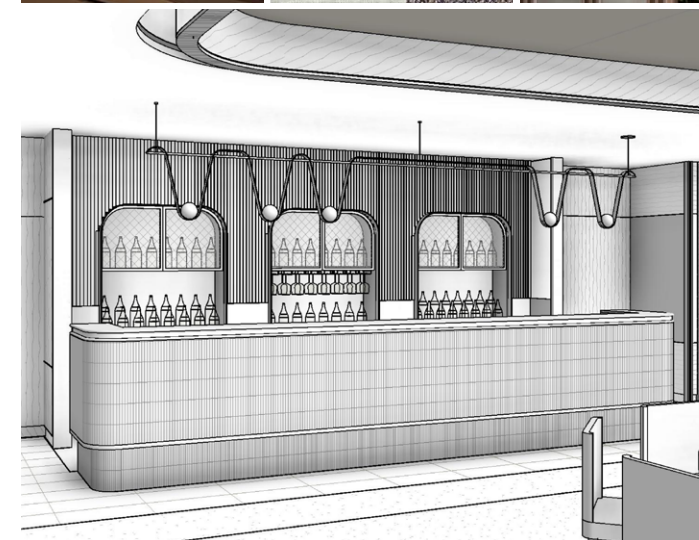

Function Rooms and Bar Facilities

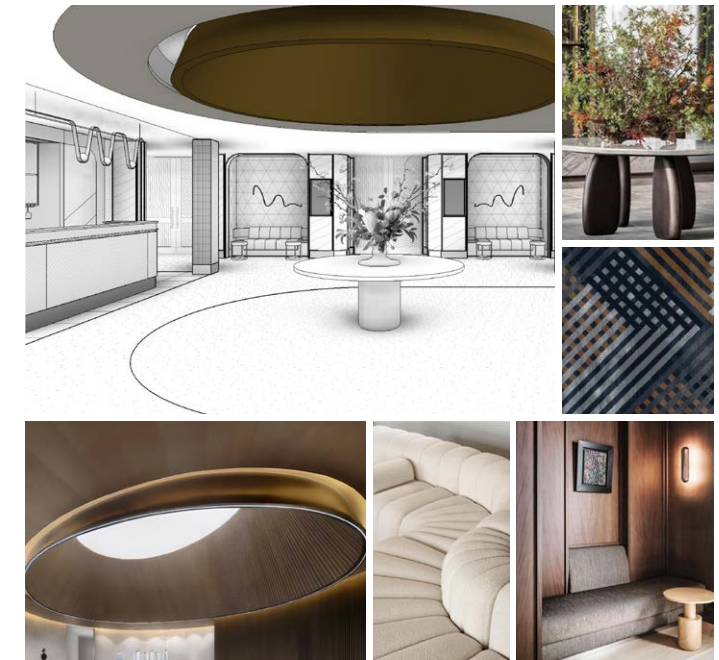

Pre-Function Space

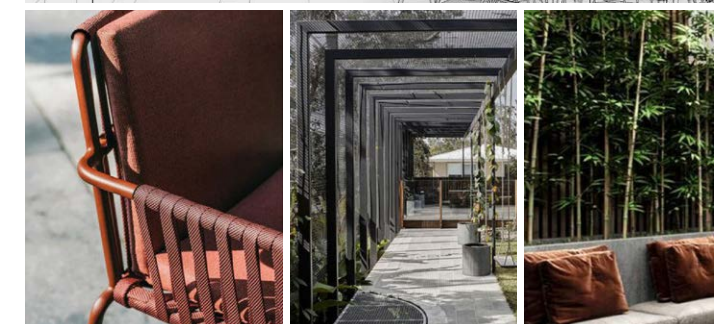

Outdoor Terrace